



3/2 28 GRAY STREET
FINNIESTON

www.domus-letting.co.uk





3 | BEDROOMS

1 | BATHROOM

1 | PUBLIC ROOM

A spacious and well-proportioned top-floor HMO flat, ideally positioned on Gray Street in the heart of Finnieston – directly opposite the Western Tennis Club and a short walk from Kelvingrove Park and Museum.

Forming part of a traditional blonde sandstone tenement, this four-bedroom flat offers flexible accommodation and is well suited for students or professionals. The property has recently been updated with new carpets and is presented in walk-in condition.

Internally, the flat comprises a large central hallway with excellent storage, a bright lounge with leather sofas, and a modern dining kitchen with stylish cabinetry, ample worktop space, and all appliances included.

There are three generous double bedrooms, each furnished with a bed, desk, and storage. A fourth bedroom provides additional space that is ideal for storage or occasional use. The bathroom has also been upgraded and features both a bath and separate shower, along with a WC and vanity unit. Further benefits include gas central heating, secure entry, and on-street permit parking.

The location is a real highlight – with local shops, cafes, and restaurants just around the corner, and excellent access to the University of Glasgow, city centre, and West End amenities.

Available furnished. HMO licensed.





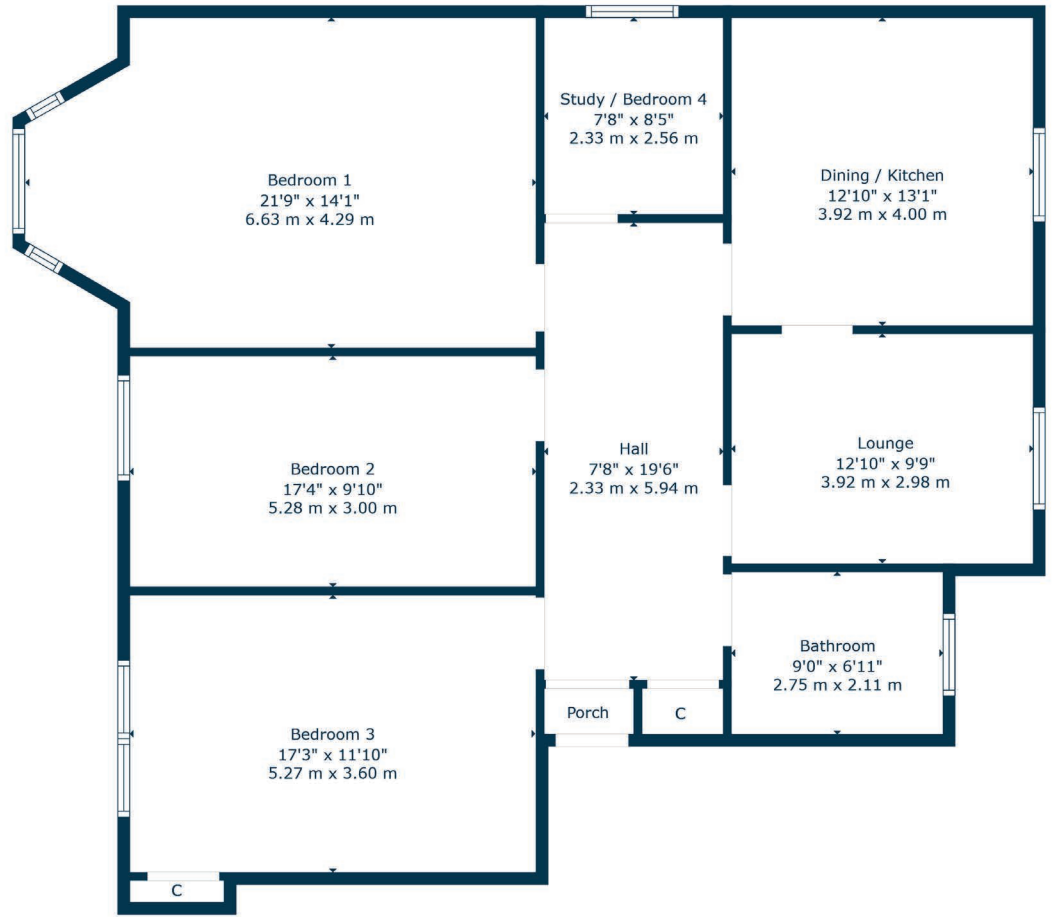

Property ID: 57 | Sat Nav: 3/2 28 Gray Street, Finnieston, Glasgow, G3 7TY

To find out more about this property, visit www.domus-letting.co.uk

* All measurements and distances are approximate Floorplans are for illustration purposes and may not be to scale.





Domus Letting
20 Blythswood Square, Glasgow, G2 4BG

Tel: 0141 428 4422

Email: lettings@domus-letting.co.uk

www.domus-letting.co.uk

LARN:2409007



Let with confidence

www.domus-letting.co.uk