



3/1, 4 JOHNSTON STREET
PAISLEY

www.domus-letting.co.uk

domus



2 | BEDROOMS

1 | BATHROOM

1 | PUBLIC ROOM

Situated in a great location and close to various shops, cafes, bars and restaurants. The Paisley Shopping Centre is also situated walking distance. The property has various transport links close by with bus routes and Paisley Canal Railway Station less than half a mile.

The property comprises a good sized lounge with sofas and bay window adding plenty of natural light, dining table and furnishings. The modern separate kitchen comprises of neutral wall and base units, tiled flooring, tiled splash backs and various kitchen appliances including cooker, hob, washing machine and fridge/freezer.

The property comprises two bedrooms of which both are double. Each bedroom comes with bedroom furniture, double bed with mattress, chest of drawers, side table and wardrobe. The bathroom comprises three piece white suite with shower over bath, wash hand basin, WC and heated towel rail.

The property further benefits from Gas Central Heating and double glazing throughout making this a nice warm property especially in the colder months.



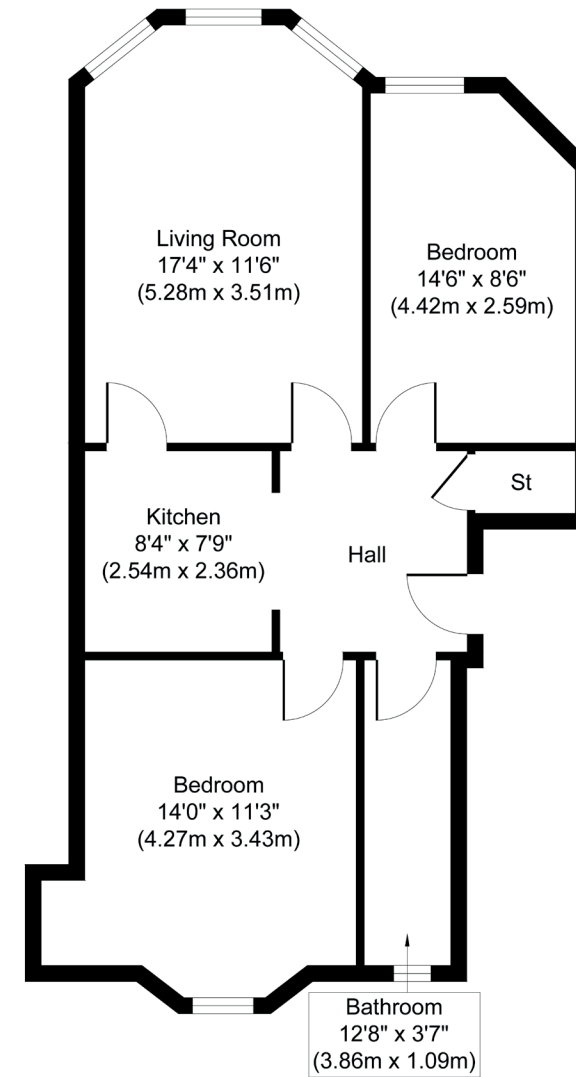

Located on Johnston Street in the heart of Paisley, this property enjoys great access to shops, cafés, and local transport. Paisley Gilmour Street Station is just a short walk away - ideal for quick links to Glasgow and beyond. The area is also home to the University of the West of Scotland and is benefiting from major investment, including upgrades to the town hall, museum, and library.

Property ID: **13** | Sat Nav: **4 Johnston Street, Paisley, PA1 1XG**

To find out more about this property, visit www.domus-letting.co.uk

* All measurements and distances are approximate Floorplans are for illustration purposes and may not be to scale.



Domus Letting
20 Blythswood Square, Glasgow, G2 4BG

Tel: 0141 428 4422

Email: lettings@domus-letting.co.uk

www.domus-letting.co.uk

LARN:2409007



Let with confidence

www.domus-letting.co.uk