



# THE HAYLOFT

LENNOXLEA FARM LENNOXTOWN

[www.domus-letting.co.uk](http://www.domus-letting.co.uk)







3 | BEDROOMS

2 | BATHROOMS

1 | PUBLIC ROOM

**This beautifully converted three-bedroom barn is nestled in a peaceful rural setting on the outskirts of Lennoxtown. It offers a perfect blend of modern living and countryside tranquility, making it an ideal home for those seeking a relaxed pace of life.**

The ground floor features a bright and airy lounge with stunning views of the Campsie Hills. The room is filled with natural light, pouring in through the large windows, and is perfect for relaxing and taking in the beautiful surroundings. The kitchen is fully fitted with modern appliances and there is a separate utility room, providing ample storage and laundry facilities. A double bedroom and a bathroom with a three-piece suite complete the ground floor, offering a convenient and comfortable living space.

Upstairs, there are two further double bedrooms, both with stunning views of the surrounding countryside. The rooms are light and airy, with ample storage space and comfortable living areas. A shower room completes the upstairs accommodation, providing a convenient and modern bathroom facility.

The property benefits from a range of modern features, including triple glazing, an air-source heat pump, and underfloor heating. These features not only provide a comfortable and warm living space but also help to reduce energy costs and minimise the property's carbon footprint.







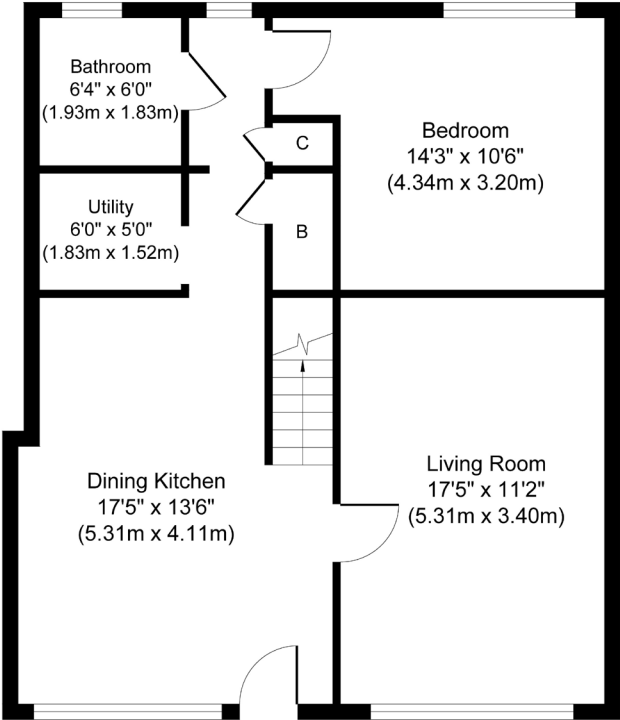

**Ground Floor**  
**Approximate Floor Area**  
**723 sq. ft**  
**(67.21 sq. m)**

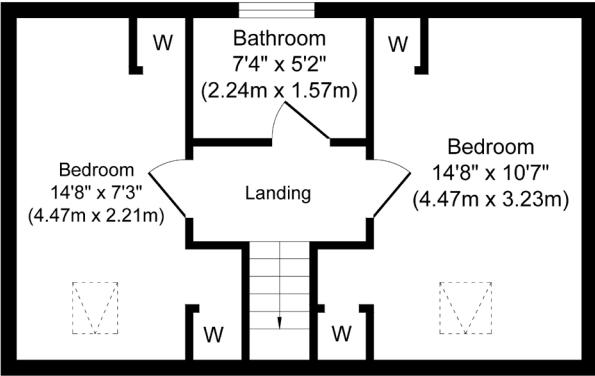

**First Floor**  
**Approximate Floor Area**  
**355 sq. ft**  
**(33.04 sq. m)**



The property is set in a peaceful rural location, with open views of the Campsie Hills. It is accessed via a private lane off Campsie Road and is convenient for Lennoxtown, Lenzie, Kirkintilloch, and Glasgow city center. The surrounding countryside offers a range of outdoor pursuits, including walking, cycling, and horse riding, making it an ideal location for those who enjoy the outdoors.

Garden maintenance is included in the monthly rent, providing a hassle-free living experience. Local schools and amenities are nearby, including shops, restaurants, and community facilities. The property is also conveniently located for commuting to Glasgow city center, with regular bus and train services available.

This beautifully converted barn offers a unique opportunity to enjoy rural living with modern comforts. Its peaceful location, stunning views, and modern features make it an ideal home for those seeking a relaxed pace of life.

Property ID: **89** | Sat Nav: **The Hayloft, Lennoxlea Farm, Glasgow, G667NN**

To find out more about this property, visit [www.domus-letting.co.uk](http://www.domus-letting.co.uk)

\* All measurements and distances are approximate Floorplans are for illustration purposes and may not be to scale.



Domus Letting  
20 Blythswood Square, Glasgow, G2 4BG

**Tel:** 0141 428 4422

**Email:** [letting@domus-letting.co.uk](mailto:letting@domus-letting.co.uk)

**[www.domus-letting.co.uk](http://www.domus-letting.co.uk)**

LARN:2409007



*Let with confidence*

[www.domus-letting.co.uk](http://www.domus-letting.co.uk)